

Susan's Storage Bin Shelves

(C) Copyright 2020
Paul J. Bennett - all rights reserved

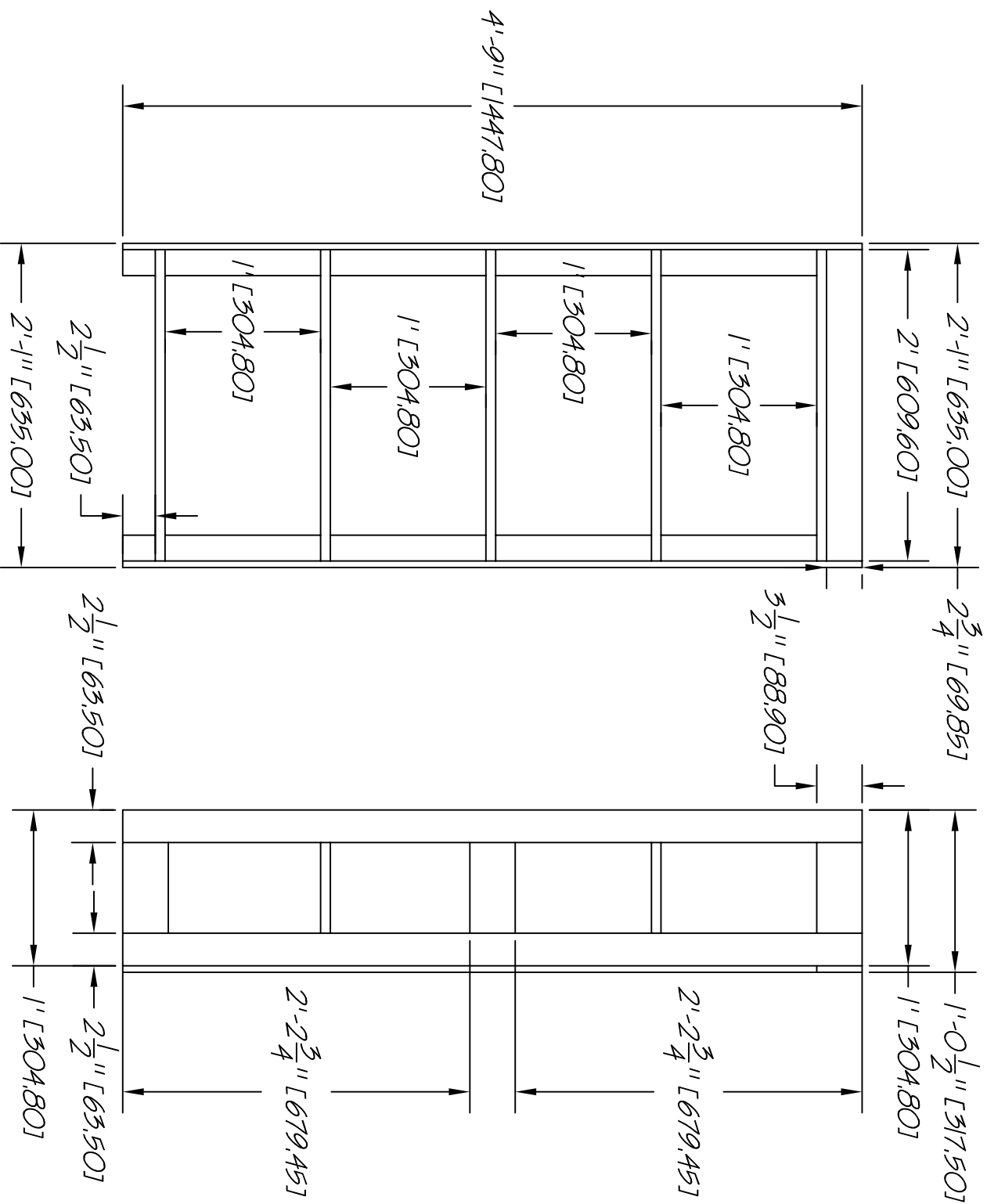

Susan's Storage Bin Shelves

(C) Copyright 2020

Paul J. Bennett - all rights reserved

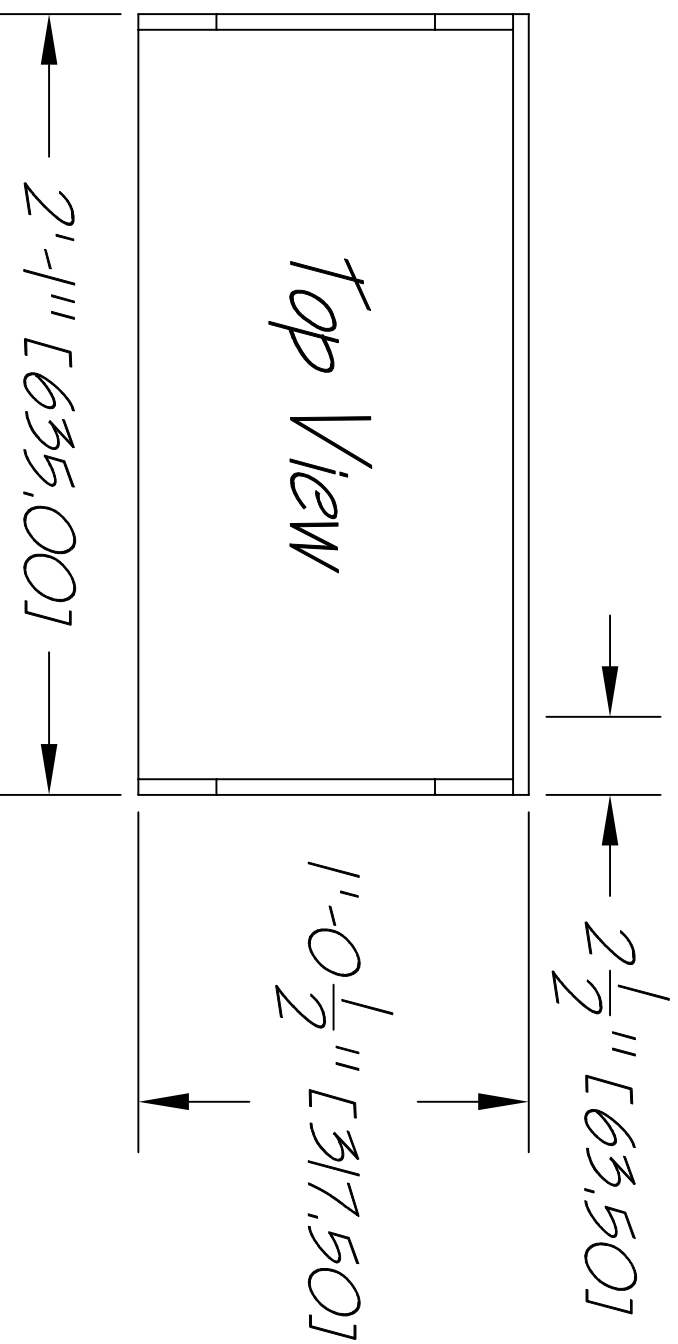

Susan's Storage Bin Shelves (Notes)

- 1) All structural components that hold shelves are $\frac{1}{2}$ " plywood and are fastened with wood glue and pocket screws.**
- 2) All shelves are $\frac{3}{4}$ " plywood and fastened with wood glue and screws.**
- 3) Finish is your personal choice.**
- 4) Dimensions may be modified to fit different size storage bins.**
- 5) Height of unit may be made taller or shorter, with shelves added or subtracted as required.**
- 6) Can be used as a book shelf, or as a vendor display rack.**