

Shoestring Shipyard Shop Jig Series Shoestring Shipyard Sawhorses

Scale: 3 / 4" = 1"

DWG # SJ-101

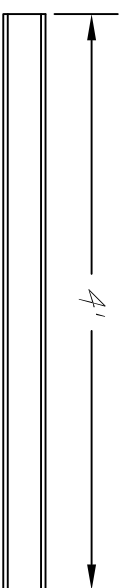

Shut Top View
Cut From 2x4 KD Stud (2) Req.
For 2 Sawhorses

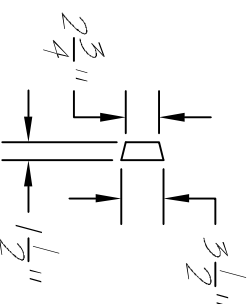

Shut Cross Section

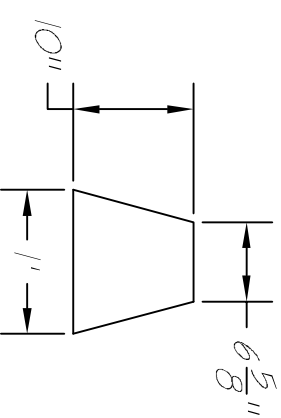

1 / 2" Plywood Gussets
(8) Req. for 2 Sawhorses

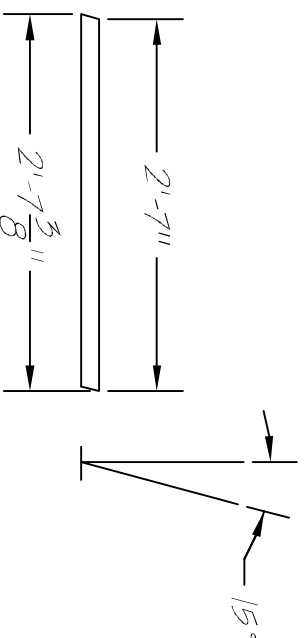

Legs
Cut From 2x4 KD Studs (8) Req.
For 2 Sawhorses

Designed by: Paul J. Bennett
(C) 2012 Shoestring Shipyard
All Rights Reserved